

PARKS AND GARDENS SECTION.
DEPARTMENT OF THE INTERIOR.

725905

No.

LDP:JLB

22nd February, 1951

MEMORANDUM:

The Senior Lands & Agricultural
Officer,
Property and Survey Branch.

FENCING : BOTANIC GARDEN SITE.

It would be appreciated if netting fencing could be arranged as indicated in red on the attached plan, in accordance with approval for the withdrawal of certain areas for Botanic Garden purposes.

The necessary wire netting will be available within this Section, and it is anticipated that the plain wire will be found on the site either in existing fences or from additional supplies which are available.

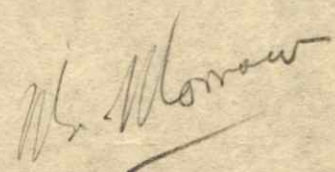

(L.D. Pryor)
Superintendent,
Parks and Gardens.

Attach.

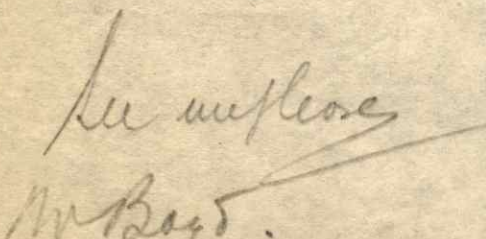

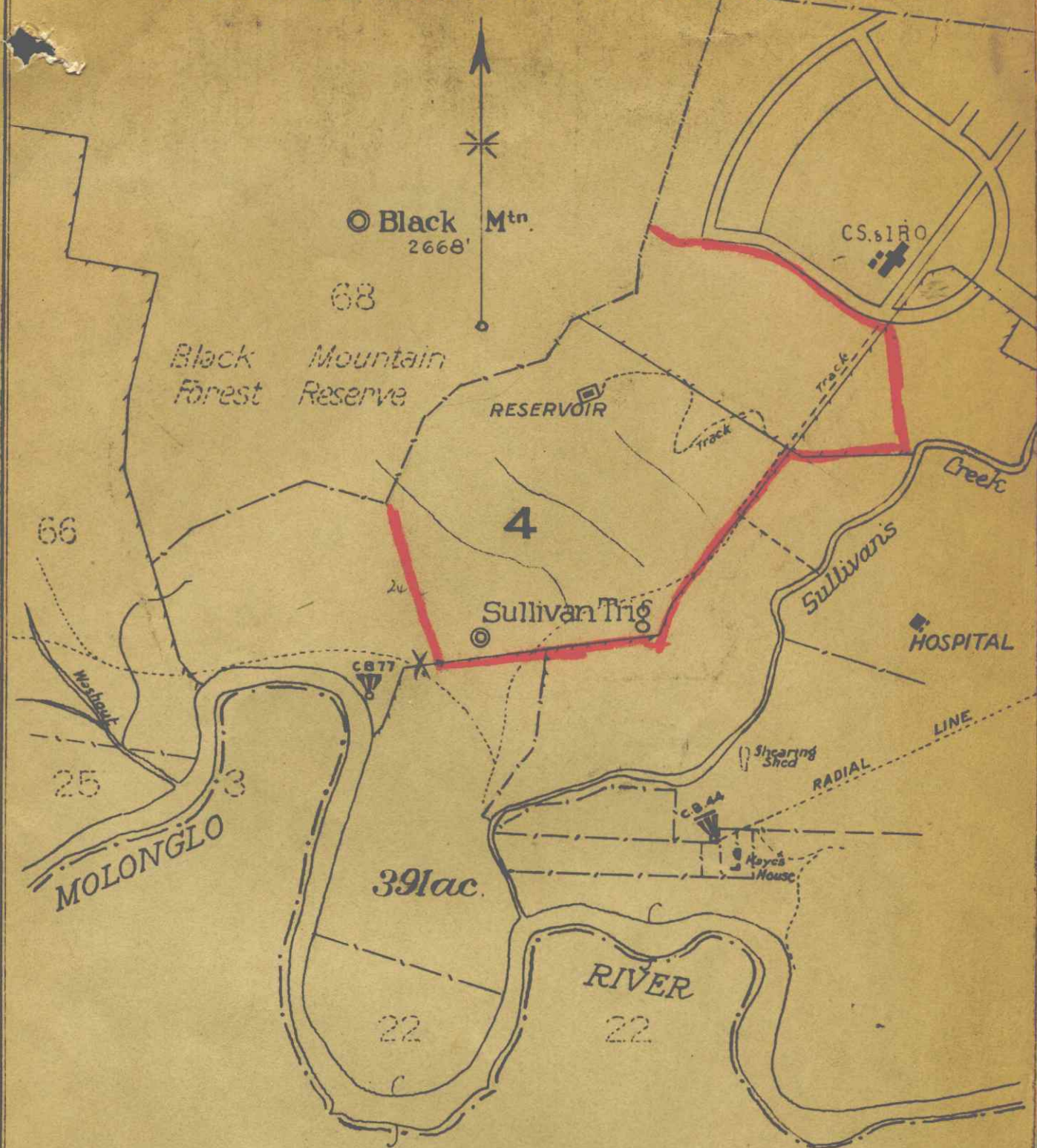

COMMONWEALTH OF AUSTRALIA



Drawn by <i>E</i>	Date 1-2-38	<h2>BLOCK 4</h2> <h3>CANBERRA CITY DISTRICT</h3> <h4>Federal Capital Territory</h4> <p>Scale 20 Ch to an Inch</p>	Surveyed by..... Date of Survey..... Azimuth..... Comput. Sheet..... F.B.....
Traced "			<h1 style="font-size: 2em;">M.S. 43</h1>
Examd. " <i>F.A.M.</i>	2-2-38		